



**PRELIMINARY INFORMATION FORM (PIF) for INDIVIDUAL PROPERTIES**

*Note: PIFs are prepared by applicants and evaluated by DHR staff and the State Review Board based on information known at the time of preparation. Recommendations concerning PIFs are subject to change if new information becomes available.*

**DHR No. (to be completed by DHR staff)** 065-0084

**1. General Property Information**

Property name: Jacobus

Property address: 11500 Bayside Road

City or Town: Machipongo

Zip code: 23405

Name of the Independent City or County where the property is located: Northampton

Category of Property (choose only one of the following):

Building X                      Site \_\_\_\_\_                      Structure \_\_\_\_\_                      Object \_\_\_\_\_

**2. Physical Aspects**

Acreage: 450

Setting (choose only one of the following):

Urban \_\_\_\_\_ Suburban \_\_\_\_\_ Town \_\_\_\_\_ Village \_\_\_\_\_ Hamlet \_\_\_\_\_ Rural X

Briefly describe the property's overall location and setting, including any notable landscape features:

Located off Jacobus Creek on 450 acres; centrally centered, with two freshwater ponds. The land is in the Eastern Shore Land Trust. Approximately 150 acres is in cultivation; the rest is forest and shoreline.

### 3. Architectural Description

Architectural Style(s): Transition from Federal to Greek Revival

If the property was designed by an architect, landscape architect, engineer, or other professional, please list here: \_\_\_\_\_

If the builder is known, please list here: influenced by Thomas Ustick Walter

Date of construction (can be approximate): 1835

#### **Narrative Description (Please do not exceed one page in describing the property):**

Briefly describe the property's general characteristics, such as its current use (and historic use if different), as well as the primary building or structure on the property (such as a house, store, mill, factory, depot, bridge, etc.). Include the materials and method(s) of construction, physical appearance and condition (exterior and interior), and any additions or other major alterations.

Jacobus Farm is a fine example of an Eastern Shore house with additions added side by side. The exterior is beaded clapboard except the old kitchen which is plain. The main house is a two over two room structure with a center hall. A handsome stair rises to the third floor. Wood with cedar-shake roof. Many shutters are original. All windows are original glass and sash. Doors are original. Heart pine original floors. Most doors have original hardware and locks. Original mantels, a total of four, as well as original cooking fireplace. Root cellar in the basement. 9 over 6 window running from 2nd to 3rd floor for light. Fan window above the front door.

In a bullet list, include any outbuildings or secondary resources or major landscape features (such as barns, sheds, dam and mill pond, storage tanks, scales, railroad spurs, etc.), including their condition and their estimated construction dates.

- Metal barn, constructed 1995
- Dam and mill pond constructed around 45 years ago (mill no longer extant)
- Cemetery dates to 1840s, per grave marker

**4. Property's History and Significance (Please do not exceed one page)**

Briefly explain the property's historic importance, such as significant events, persons, and/or families associated with the property.

If the property is important for its architecture, engineering, landscape architecture, or other aspects of design, please include a brief explanation of this aspect.

Turkey hunt, hosting Virginia Governor Ralph Northam. Listed in Whitelaw's book of historic homes.

Please list all sources of information used to research the history of the property, such as deeds, census and tax records, and/or published articles and books. (It is not necessary to attach lengthy articles or family genealogies to this form.)

- TAX RECORDS
- OFFICE DEEDS County Courthouse
- WHITE LAWS HISTORY Northampton County Page 349 Vol. I
- GRAVESTONE INSCRIPTIONS IN Northampton Co VA.

**5. Property Ownership** (Check as many categories as apply):

Private:  Public\Local  Public\State  Public\Federal

**Current Legal Owner(s) of the Property** (If the property has more than one owner, please list each below or on an additional sheet.)

name/title: DONALD M. BRENNAN

organization: \_\_\_\_\_

street & number: 11500 BAYSIDE RD

city or town: Machipongo state: VA zip code: 23405

e-mail: DMB.11500@yahoo.com telephone: 347-541-0670

Legal Owner's Signature: Donald Brennan

Date: 06/27/2024

•• Signature required for processing all applications. ••

In the event of corporate ownership you must provide the name and title of the appropriate contact person.

Contact person: \_\_\_\_\_

Daytime Telephone: \_\_\_\_\_

**Applicant Information** (Individual completing form if other than legal owner of property)

name/title: \_\_\_\_\_

organization: \_\_\_\_\_

street & number: \_\_\_\_\_

city or town: \_\_\_\_\_ state: \_\_\_\_\_ zip code: \_\_\_\_\_

e-mail: \_\_\_\_\_ telephone: \_\_\_\_\_

Date: \_\_\_\_\_

PLEASE DO NOT ATTACH CONTINUATION SHEETS TO THIS FORM. THANK YOU!

# LOCATION MAP

a la mode, Inc.

MapPoint



# SITE PLAN OF SUBJECT PROPERTY

## Exhibit B: Map of Protected Property Jacobus, Donald M. Brennan



Legend	
	Protected Property Boundary
	Chesapeake Bay Preservation Act (100 foot buffer)
	Perennial stream
	Road

Aerial Imagery Copyright Commonwealth of Virginia, 2002

1914 SURVEY

DB 73-424  
DEED BOOK

PB 4-117  
BOOK

of Jacobus Farm  
situated in the County  
of St. Lawrence, State of  
New York, and bounded  
as follows:  
on the North by  
John P. J. J. Bell and  
on the East by  
Wm. F. Thomas  
J. B. Bell

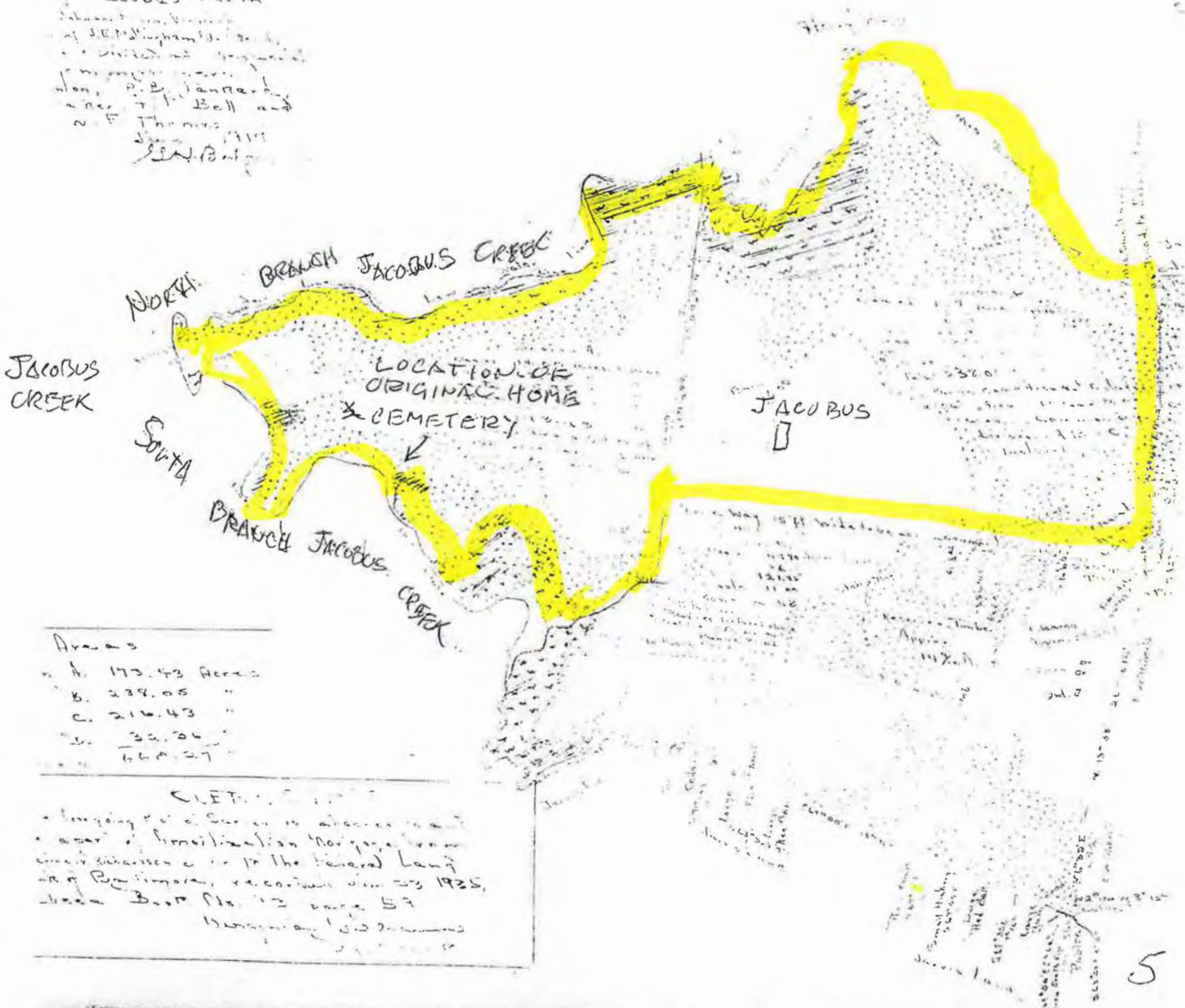

- Areas
- A. 173.43 Acres
  - B. 234.05 "
  - C. 216.43 "
  - D. 32.26 "
  - E. 668.27 "

CLERK

A large part of the Survey is adjacent to  
the water of the International Navigation Canal  
which is situated on the Federal Land  
in the County of St. Lawrence, New York, and  
is a part of the Survey No. 12 of 1925,  
Deed Book No. 12 page 59  
Harrison, J. B. Bell



































